

JUVENILE COURT HEALTH SERVICES PHARMACY PROCEDURES

Subject: VACCINE TRANSPORT: SHORT-TERM STORAGE		Original Issue Date: 08/20/12	Procedure # 039
		Supersedes: 1/30/13	Effective Date: 7/1/14
Departments Consulted: DHS Pharmacy Affairs	Approved By: (Signature on File) Pharmacy Supervisor (Signature on File) Medical Director	Approved by: (Signature on File) Health Services Administrator	

PURPOSE

The aim of this policy is to ensure the effectiveness, from delivery to the time of administration, of all vaccines (VFC, 317 and private supplies) by maintaining the vaccine cold chain.

POLICY

The pharmacy staff will adhere to the procedure below to pack vaccines to ensure that all vaccines are stored at recommended temperatures for at least 8 hours during transport to and from any juvenile hall or camp.

PROCEDURE

A. Primary System used will be the Cool Cube VT-50 for refrigerated vaccines and VT-50V for frozen vaccines.

1. Freeze TICs (at least 24 hours prior to vaccine clinic)

- a. Open the unit, unzip the bag and open.
- b. Remove the VIP Lid, flip open top panel (hinged with tape).
- c. Remove six (6) TICs from the VIP Base and place in a -18°C freezer (or below) for a minimum of 24 hours¹. Lay TICs flat.

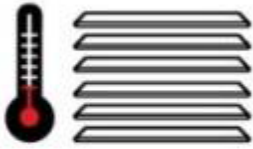

2. Stage TICs

- a. Remove TICs from the freezer (confirm TICs are fully frozen by shaking and verifying no liquid can be heard) and let sit at room temperature (staging). This time allows the inside to rise to the appropriate operating temperature.
- b. Recommended Staging Time: 25 minutes

Subject: VACCINE TRANSPORT: SHORT-TERM STORAGE	Effective Date: 1/30/13	Procedure # 039
	Health Services Administrator's Initials: (Initials on File)	



- c. NOTE: Staging times are based on a freezer temperature of -18°C and a room temperature of 22°C. TICs are not stacked during the staging time. These times are meant to serve as a guideline and may have to be adjusted based on your individual operating environment.

3. Assemble TIC Base

- a. Insert one (1) TIC into the VIP base with the Credo Cube® embossment facing up.
- b. Add four (4) TICs to form the side walls with the Credo Cube® embossment facing inward.

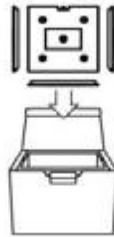

4. Load Cargo

- a. • Ensure temperature sensitive cargo is preconditioned at 5°C (+/- 3°) before loading into the TIC base.
- b. • Add non-insulating filler to fill empty cargo space to prevent contents from shifting.

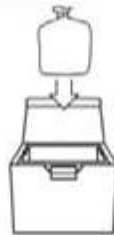

5. Insert TIC Lid

- a. Place the final TIC over the cargo area, ensuring the pane lies flat and level without forcing onto TIC side walls.

Subject: VACCINE TRANSPORT: SHORT-TERM STORAGE	Effective Date: 1/30/13	Procedure # 039
	Health Services Administrator's Initials: (Initials on File)	



6. Insert Insulator Lid

- a. Place VIP lid over the TICs, making sure it rests flat and level without forcing.
- b. Insert calibrated thermometer probe into TIC cube, store thermometer in pouch of lid.



7. Close and Secure Outer Case

- a. Close lid and zip outer bag.

B. Receipt of vaccine at Probation Halls and Camps.

- 1. Upon receipt of the vaccines, the receiving nurse will check the vaccine temperature.
- 2. If the vaccine is:
 - a. **BETWEEN 35.6°F (2 °C) and 46.4°F (8°C)**
 - Verify the type of vaccine and number of doses received match what is listed on the packaging receipt.
 - If there is a discrepancy in the order, store the vaccine in the refrigerator/freezer and notify the pharmacy.
 - b. **BELOW 35.6°F (2 °C) or ABOVE 46.4°F (8°C)**
 - Call the pharmacy at Central Juvenile Hall (x8859).
 - Pharmacy will provide assessment of the integrity of the vaccine.
 - If not viable, the nurse will place a “Do Not Use” label on the transport container. The non-viable vaccines will be returned to pharmacy for proper disposal.

REFERENCE

“Transporting Refrigerated Vaccine” California Dept. of Public Health, Immunization Branch (www.eziz.org – IMM-983 2/10)